

Recommended P/N 3427-0\*\*1

PART No.	Pos.	A	B	C	D	E
3427-0201	20	15.30	9.78	12.56	3.00	6.00
3427-0301	30	20.30	14.78	17.56	4.00	12.00
3427-0401	40	25.40	19.88	22.56	4.00	16.00

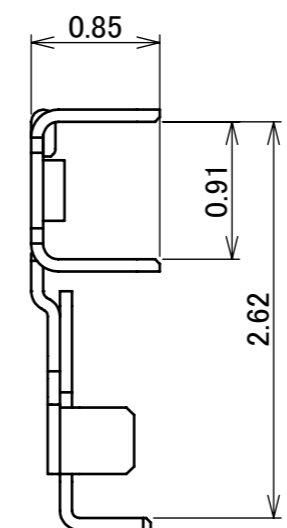

VIEW M (S=20/1)

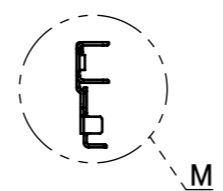
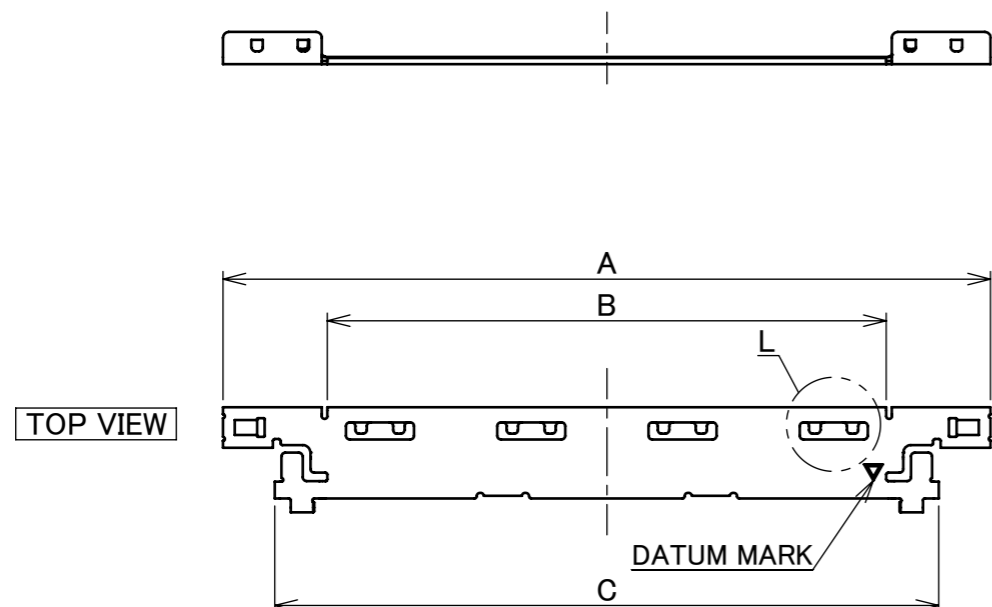
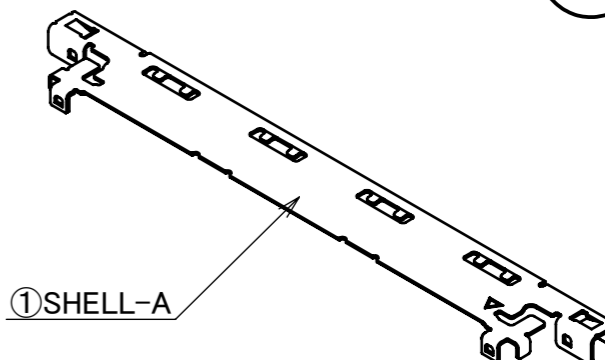
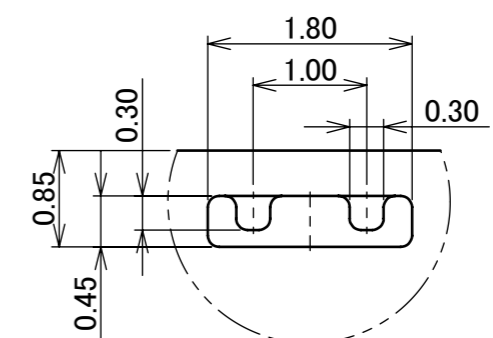

DETAIL L (S=15/1)

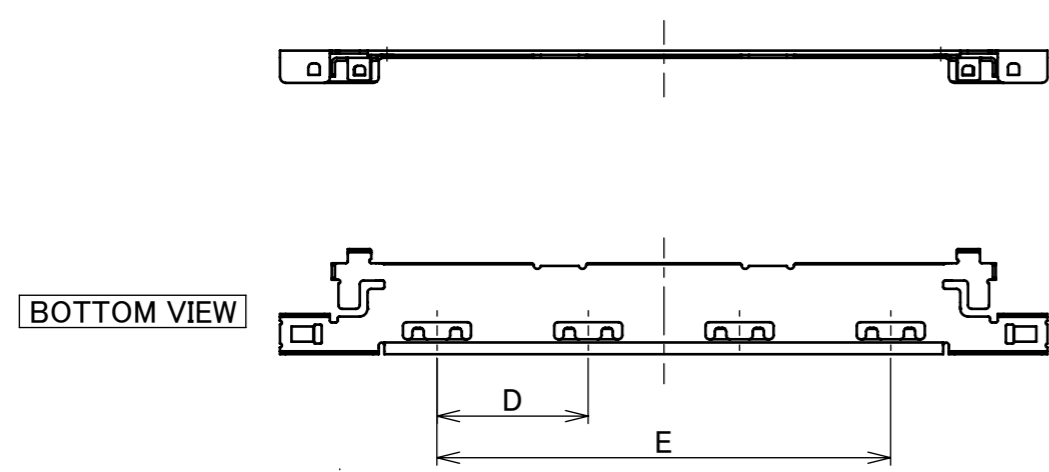

BOTTOM VIEW

NO.	DISCRIPTION	MATERIAL	FINISH , REMARKS
1	SHELL-A	PHOSPHOR BRONZE	PARTIAL Au 0.003 μ m MIN. OVER Ni 1.00 μ m MIN.

**PATENT REGISTERED**

REV.	ECN	BY	DATE	APP.	ANGLE	6 OVER 30 MAX.	±0.3	PROJECTION	SERIES No.	CUSTOMER COPY		
3	Z191128	M.N	Aug./27/'19	H.I	±2°	6 OVER 30 MAX.	±0.3		R1	CUSTOMER COPY		
2	Z180939	K.B	July/19/'18	Y.S	6 MAX. ±0.2	30 OVER 120 MAX.	±0.5					
REVISION RECORD					GENERAL TOLERANCE.				R1	CUSTOMER COPY		
1	Z171217	K.B	Oct./23/'17	Y.S	DWG. K.Baba	DATE 2017/07/25	TITLE CABLINE®-VS II PLUG SHELL-A				SCALE	I-PEX
0	Z170854	K.B	July/25/'17		CHK. T.Kurachi	DATE 2017/07/25					5:1	
					APP. Y.Shimada	DATE 2017/07/26	DWG. No. 3427	UNIT mm				
								SIZE A3	SHEET 1/2	REV. 3		

PART No.	Pos.	F	G	QTY. PER EMBOSS REEL (PIECES / REEL)	QTY. PER PACKING CARTON (REELS / CARTON)	PACKING STANDARD
3427-0201	20	30.00	24.50	6000 / REEL	3 / CARTON = 18000	PST-17077
3427-0301	30	35.00	29.00			
3427-0401	40	40.00	33.00			

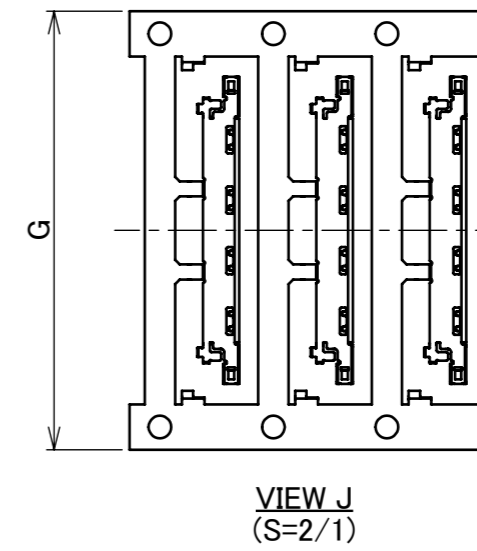
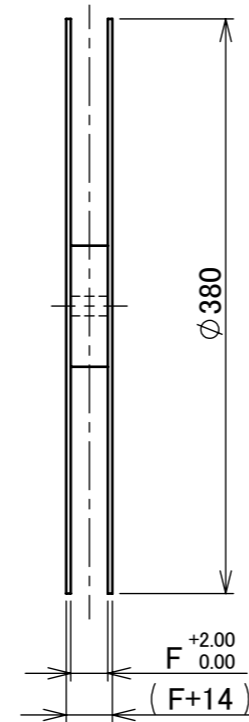
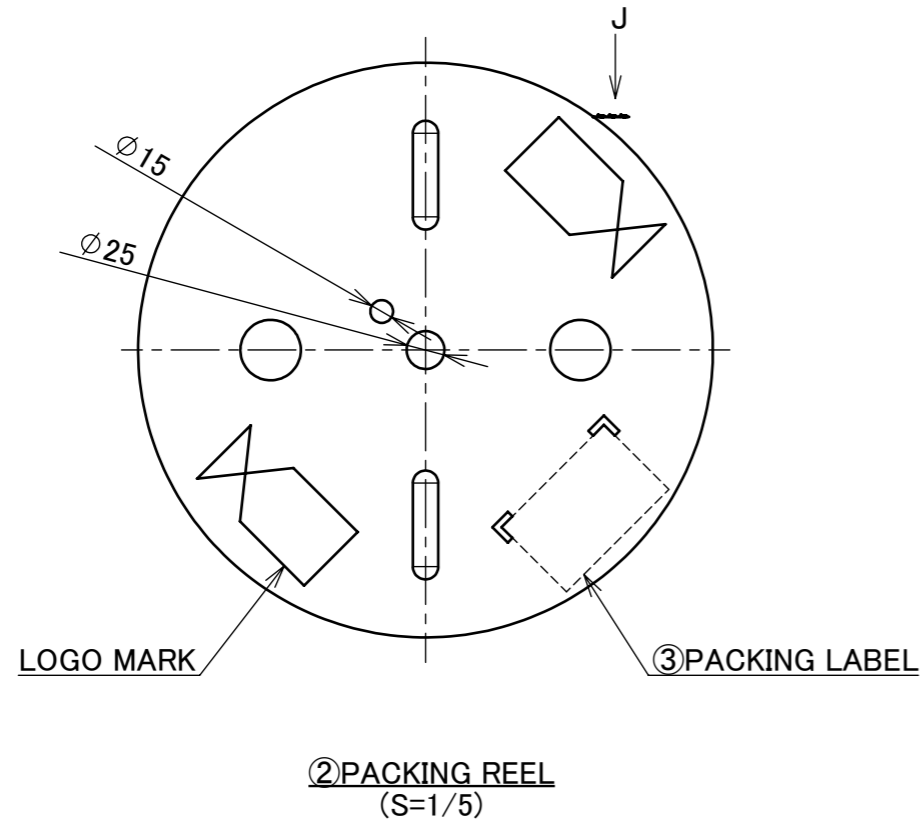

NO.	DISCRIPTION	MATERIAL	FINISH , REMARKS
3	PACKING LABEL	-	-
2	PACKING REEL	CARDBOARD	-

ANGLE	$\pm 2^\circ$	6 OVER 30 MAX.	$\pm 0.3$	PROJECTION	SERIES No.	CUSTOMER COPY
6 MAX.	$\pm 0.2$	30 OVER 120 MAX.	$\pm 0.5$		R1	
GENERAL TOLERANCE.				TITLE	SCALE	
DWG.	DATE		CABLIN <sup>®</sup> -VS II PLUG SHELL-A	5:1		
CHK.	DATE			UNIT		
APP.	DATE			mm		
				DWG. No.	SIZE	SHEET
				3427	A3	2/2
						REV. 3