

PART No.
20668-001R-13

Offered as harness only.

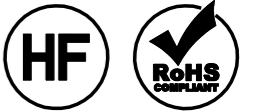
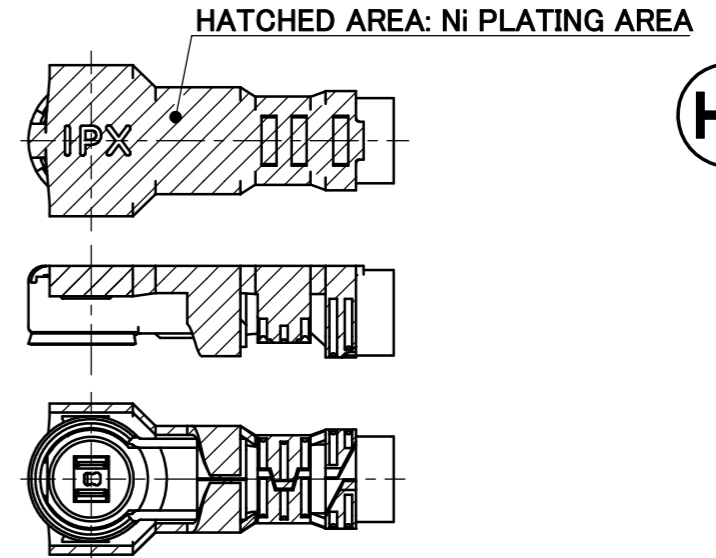
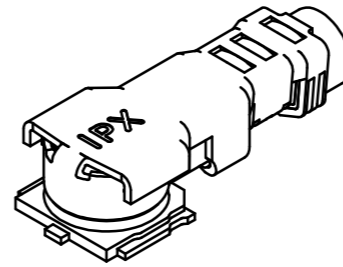
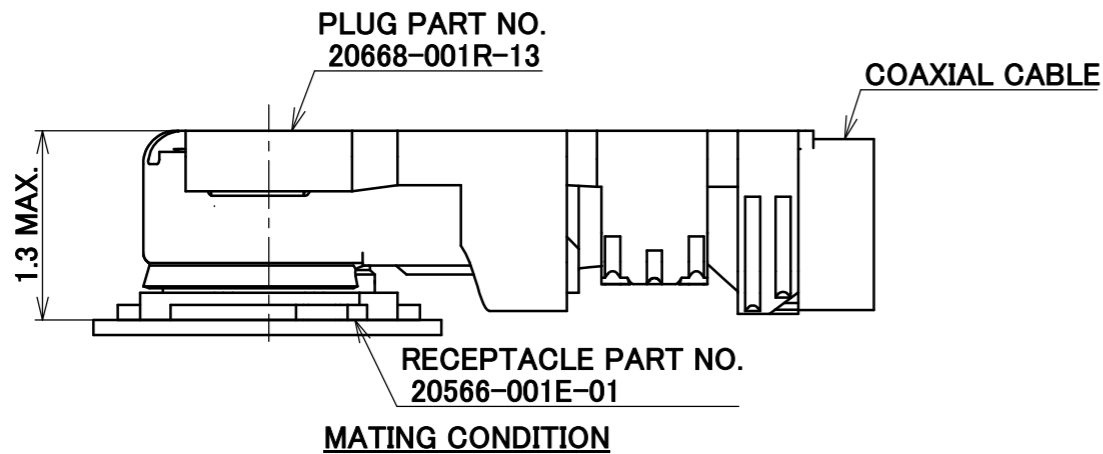
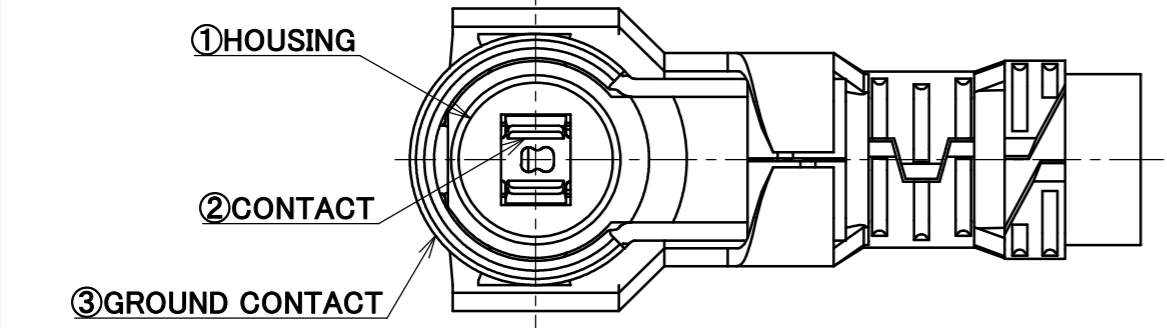
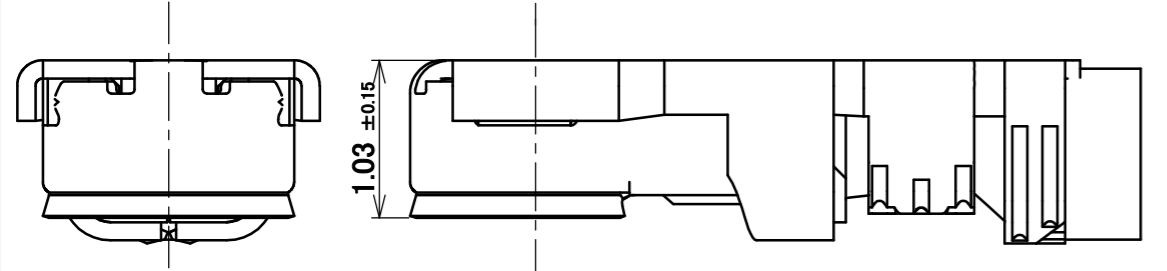
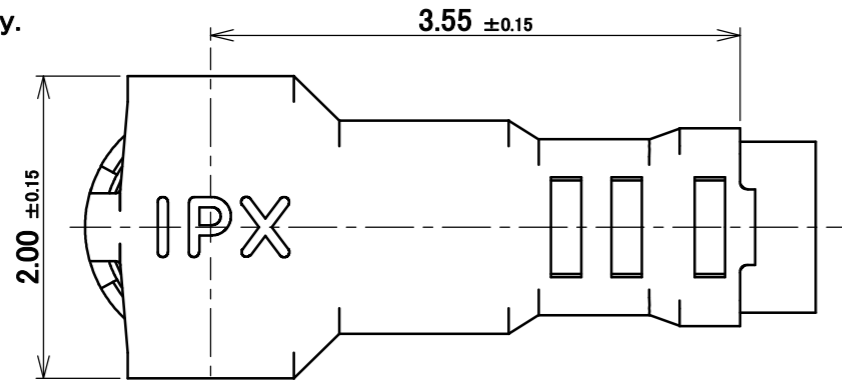

NOTES.

1. APPLICABLE CONNECTOR: 20566-001E-01
2. PERMISSIBLE LOAD OF CABLE AT MATING
3. MATING AND UNMATING INSTRUCTION
 - 3-1. MATING
MATE THE CONNECTOR VERTICALLY AS MUCH AS POSSIBLE, ADJUSTING THE MATING AXIS OF PLUG AND RECEPTACLE. DO NOT SLANT MATE.
 - 3-2. UNMATING
 - 3-2-1. IN CASE OF UNMATING BY PULLING TOOL (PART NO. 90612-0001)
USE THE PULLING TOOL AS THE FOLLOWING DRAWING, AND PULL PLUG TO VERTICAL DIRECTION AS DIRECTLY AS POSSIBLE.
 - 3-2-2. IN CASE OF UNMATING DIRECTLY BY HAND
CATCH THE CATCHING AREA OF PLUG, AND PULL PLUG TO VERTICAL DIRECTION AS DIRECTLY AS POSSIBLE.

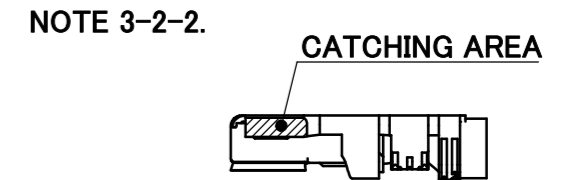
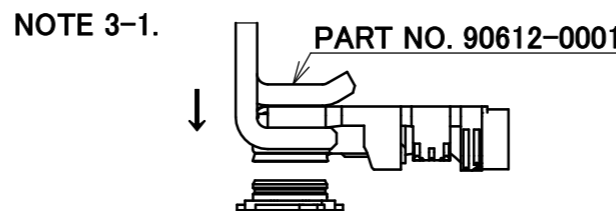
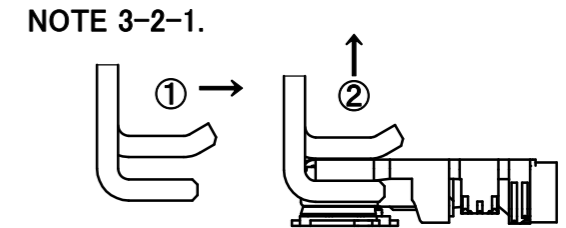
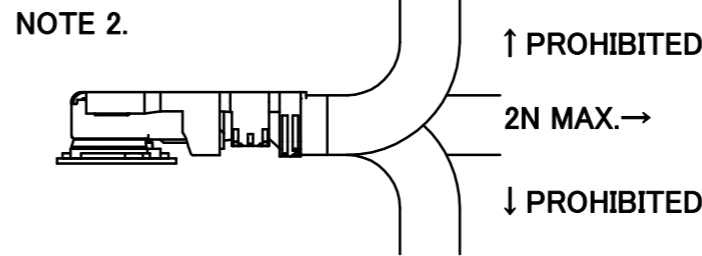

NO.	DESCRIPTION	MATERIAL	FINISH , REMARKS
3	GROUND CONTACT	PHOSPHOR BRONZE	ALL OVER Ni 1.00 μm MIN. CONTACT PART Au 0.05 μm MIN. [Ni PLATING AREA] Ni ONLY
2	CONTACT	PHOSPHOR BRONZE	ALL OVER Ni 1.00 μm MIN. CONTACT PART Au 0.05 μm MIN.
1	HOUSING	LCP	UL94V-0, BLACK (GF 30%)

REV.	ECN	BY	DATE	APP.	ANGLE	PROJECTION	SERIES No.	CUSTOMER COPY
					±2° 6 OVER 30 MAX. ±0.3 6 MAX. ±0.2 30 OVER 120 MAX. ±0.5		R1	
3	Z190990	K.T	2019/07/30	Y.S	GENERAL TOLERANCE.		TITLE	SCALE
2	Z181728	M.N	2018/12/27	Ken	DWG. Y.Imaji	DATE 2016/01/20	MHF® 5L PLUG Ni TOP (1.13)	20:1
1	Z180759	M.N	2018/09/14	Ken	CHK. Y.Hashimoto	DATE 2016/01/20		UNIT mm
0	Z160045	Y.I	2016/01/20		APP. K.Yotsutani	DATE 2016/01/20	DWG. No. 20668	SIZE A3
REVISION RECORD								SHEET 1/3 REV. 3

ITEMS	SPECIFICATION
RECOMMENDED APPLICABLE CONNECTOR PART No.	20566-001E-01
RATING VOLTAGE	60 V AC (R.M.S)
RATING FREQUENCY	DC~12 GHz
OPERATING TEMPERATURE	233~363K (-40°C~+90°C)
VSWR	1.3 MAX. AT DC~3 GHz, 1.4 MAX. AT 3~6 GHz, 1.5 MAX. AT 6~12 GHz
MAIN CONTACT RESISTANCE	INITIAL: 20 mohm MAX. / AFTER TEST: Δ R 20 mohm MAX.
GROUND CONTACT RESISTANCE	INITIAL: 20 mohm MAX. / AFTER TEST: Δ R 100 mohm MAX.
INSULATION RESISTANCE	INITIAL: 500 Mohm MIN. / AFTER TEST: 100 Mohm MIN.
DIELECTRIC WITHSTANDING VOLTAGE	200 V AC, 1 MINUTE
DURABILITY	30 CYCLES
UNMATING FORCE (INITIAL / AFTER TEST)	INITIAL: 5 N MIN. / AFTER TEST: 3 N MIN.
CRIMP STRENGTH	10 N MIN.
PRODUCT SPECIFICATION	PRS-2192
TEST REPORT	TR-16003
INSTRUCTION MANUAL	HIM-16014
APPEARANCE CRITERIA No.	QLS-A***

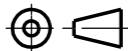
ANGLE	$\pm 2^\circ$	6 OVER 30 MAX.	± 0.3	PROJECTION 	SERIES No. R1	CUSTOMER COPY
	6 MAX.	± 0.2	30 OVER 120 MAX.			
GENERAL TOLERANCE.				TITLE MHF[®] 5L PLUG Ni TOP (1.13)	SCALE -	UNIT mm
DWG.	DATE					
CHK.	DATE					
APP.	DATE					
				DWG. No.	20668	SIZE A3
				SHEET 2/3		REV. 3

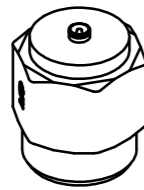

SMA ADAPTOR FOR MHF 5 PLUG
PART NO. 90543-0001



FRONT SIDE

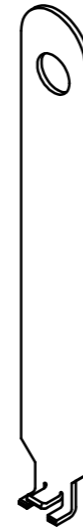

BACK SIDE

MHF 5 PUSHING AND PULLING TOOL
PART NO. 90612-0001



MHF 5 PUSHING TOOL
PART NO. 90624-0001

ANGLE	±2°	6 OVER 30 MAX.	±0.3	PROJECTION 	SERIES No. R1	CUSTOMER COPY		
6 MAX.	±0.2	30 OVER 120 MAX.	±0.5					
GENERAL TOLERANCE.				TITLE MHF® 5L PLUG Ni TOP (1.13)	SCALE 2:1	I-PEX		
DWG.	DATE							UNIT mm
CHK.	DATE							SIZE A3
APP.	DATE							DWG. No. 20668
					SHEET	3/3	REV. 3	